

QUANTUM TTC[®]

BILIARY BALLOON DILATORS

QUICK REFERENCE GUIDE

SYSTEM PREP

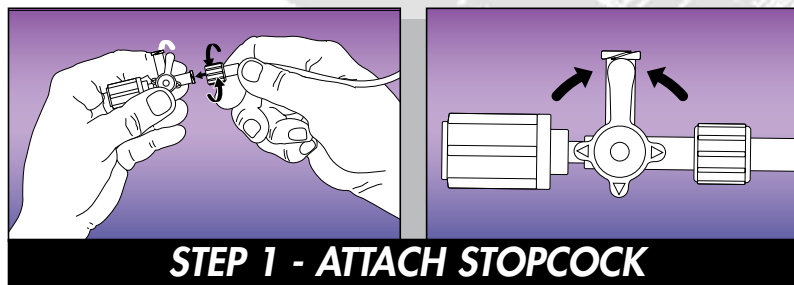
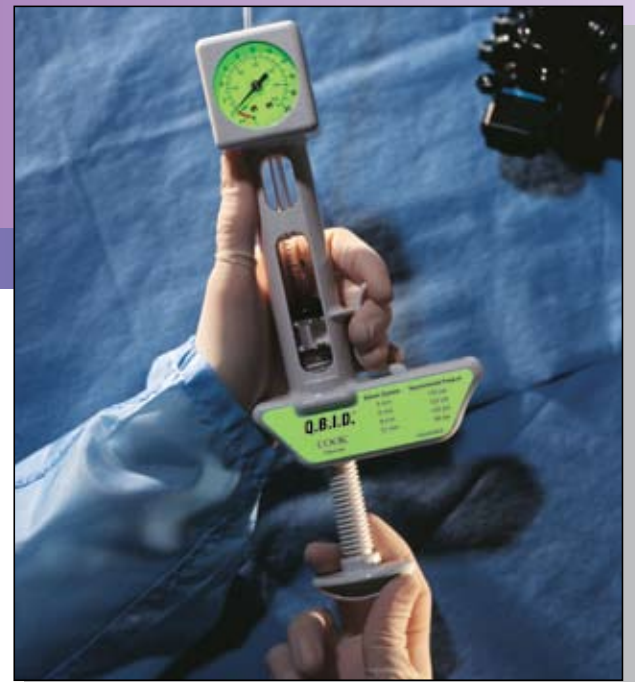
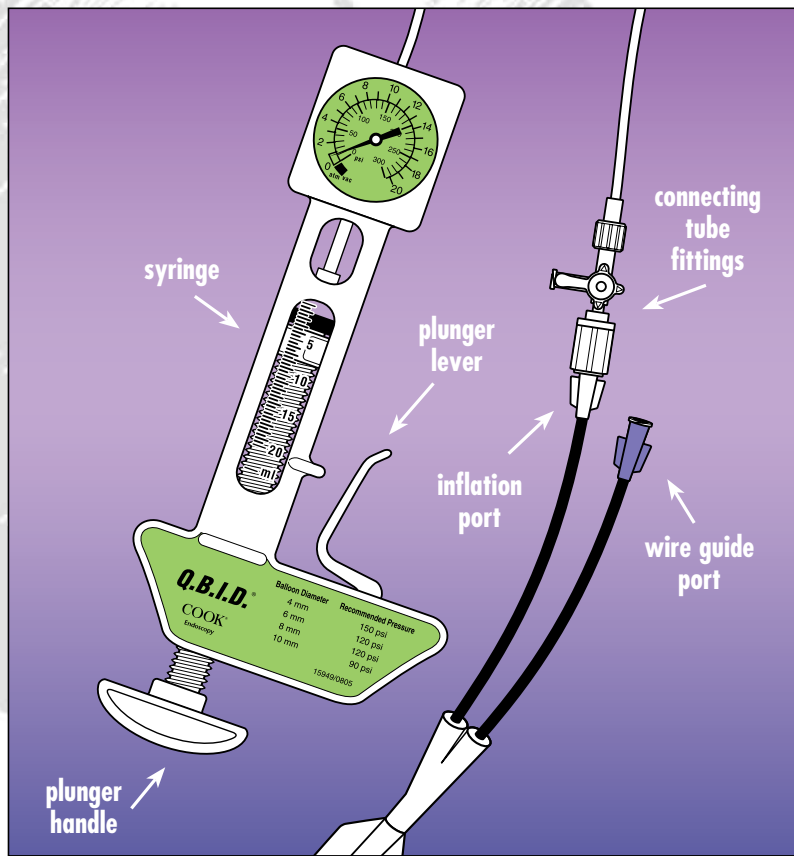

STEP 1 - ATTACH STOPCOCK

To facilitate purging of air, rotate the stopcock and the connecting tube fittings until tight. Close the stopcock by turning the "off" arm to the sideport.

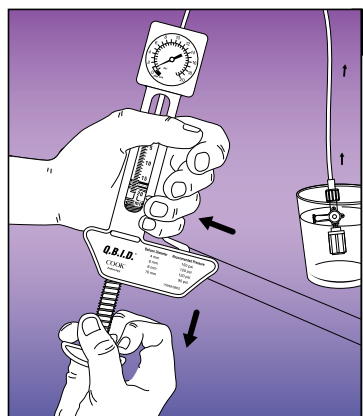

STEP 2 - FILL SYRINGE

While holding the inflation device, submerge the connecting tube in a minimum of 30 ml/cc of sterile water, saline or dilute contrast. Fill the syringe with a minimum of 15 ml/cc by compressing the plunger lever and pulling the plunger handle. Release the plunger lever to lock the plunger in place.

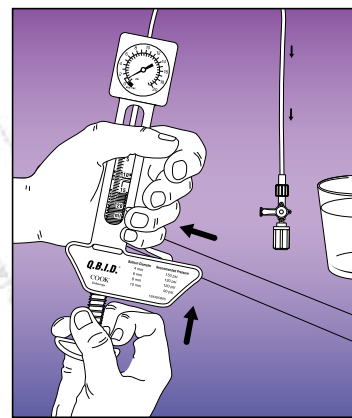

STEP 3 - PURGE AIR

To completely purge the inflation device of air, hold it upright and compress the plunger lever while simultaneously grasping and pushing the plunger handle until all air is expelled. While maintaining the position of the plunger handle, release the plunger lever to lock the plunger in place. To add fluid to the syringe, repeat step 2.

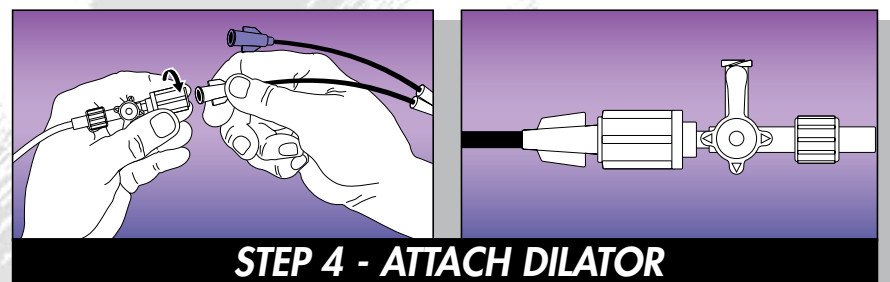

STEP 4 - ATTACH DILATOR

Attach the male Luer lock fitting of the stopcock to the hub of the balloon dilator, and secure by rotating the fittings.

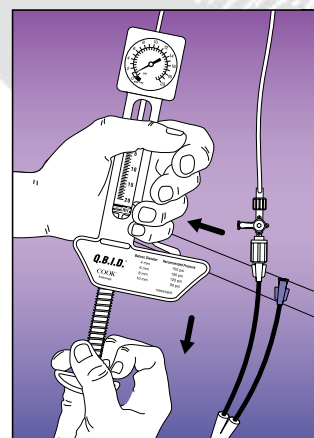

STEP 5 - DRAW VACUUM

While compressing the plunger lever, pull the plunger handle until vacuum is indicated on pressure gauge. Maintain vacuum, then release the plunger lever. The balloon dilator is now ready for placement.

COOK[®]
Endoscopy

BALLOON DILATION

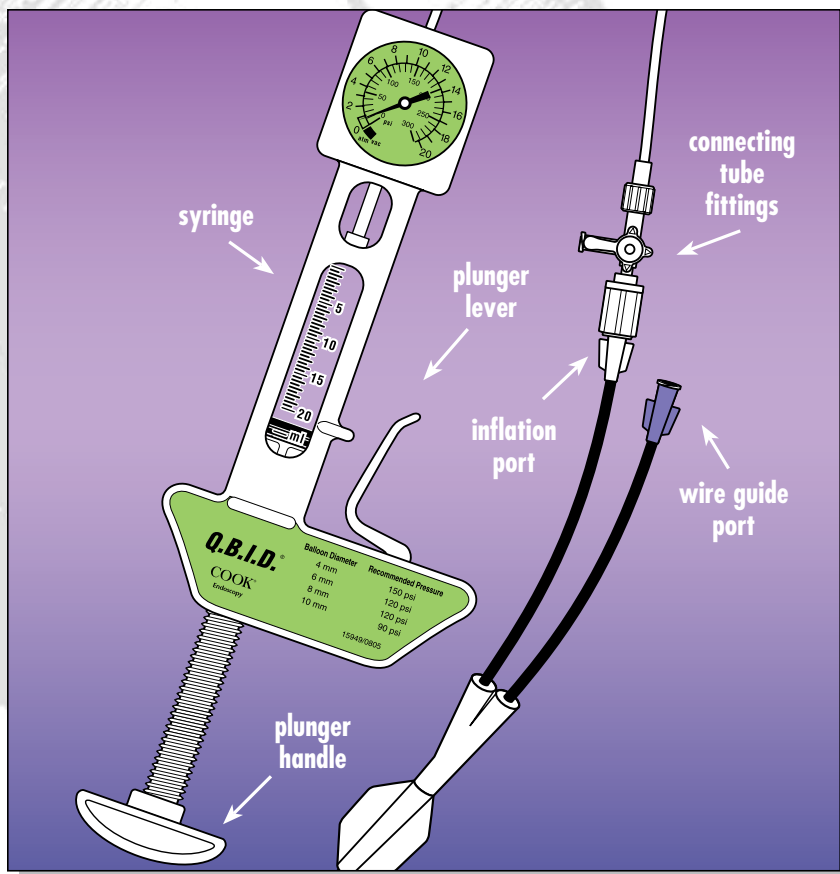

ROTATE TO INFLATE

Attach the inflation device and rotate the plunger handle for easy inflation. Check for recommended inflation pressure on device handle and balloon catheter tab.

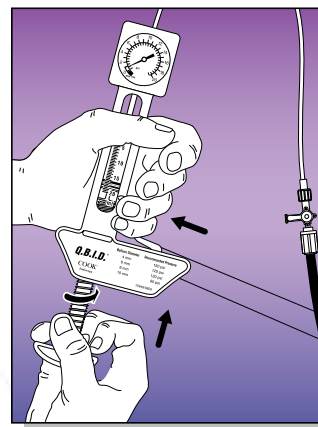

PULL BACK TO DEFLATE

Depress the plunger lever and pull the handle back. While holding the plunger handle back, release the lever to lock the handle into place. These steps will ensure effective deflation.

INTRODUCTION

1. Do not pre-inflate balloon.
2. Lubricate the balloon with water soluble lubricant prior to passage into the scope.
3. Flush the wire guide lumen with sterile water or saline.
4. Advance the balloon over the wire guide using the fluoroscopic bands to confirm balloon position. The balloon should be centered in the stricture.

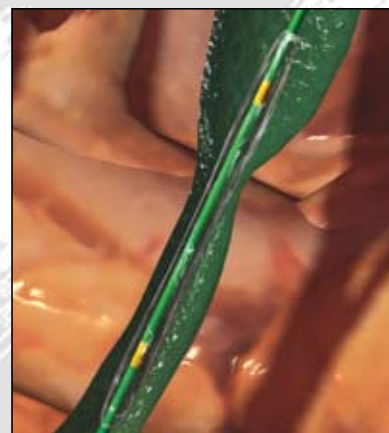

Balloon in proper position through the stricture.

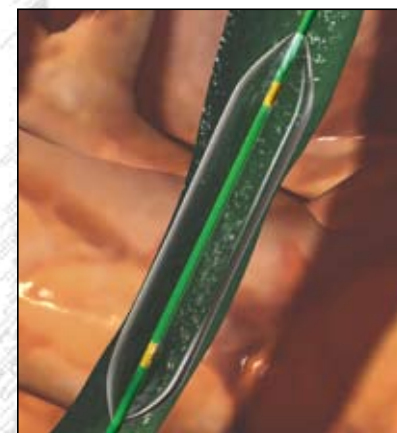

Balloon inflation may be repeated for optimal dilation.

ORDERING INFORMATION

Order Number	Inflated Balloon Diameter	Recommended Pressure	Minimum Accessory Channel
QBD-4X3	4 MM/12 FR	150 psi/10 atm	2.8 mm
QBD-6X3	6 MM/18 FR	120 psi/8 atm	2.8 mm
QBD-8X3	8 MM/24 FR	120 psi/8 atm	2.8 mm
QBD-10X3	10 MM/30 FR	90 psi/6 atm	2.8 mm

Order Number	Inflation Device
QBID-1	Quantum Biliary Inflation Device

COOK[®]

Endoscopy

4900 Bethania Station Rd. • Winston-Salem, NC 27105 • 336-744-0157
 Customer Service: 800-457-4500 (USA Only)